

A photograph of a modern, open-plan living and dining area. In the foreground, a dark wooden dining table is set for four people with white plates, glasses, and a centerpiece of white flowers. The table is surrounded by black chairs with yellow upholstered seats. In the background, a light-colored sofa faces a large window that offers a view of the city. A wooden console table with a potted plant is visible on the left. The ceiling features recessed lighting and a large circular light fixture.

STURGES
LONDON

Merchant Square, Paddington Basin, London
£7,194 Per calendar month



- 6th Floor interior designed apartment overlooking the Canal
- Features CCTV, Digital TV and Video Entry
- Lifts, Concierge, Porter and Shops
- Secure underground parking
- Modern fitted open plan kitchen
- All bedrooms have water views
- Excellent transport links including the Elizabeth Line
- Excellent entertaining space



STURGES
LONDON



, London

This amazing apartment is situated on the sixth floor of this ideally located building in the Paddington Basin overlooking the Canal. The building has a dedicated building manager, a concierge, lift service and secure underground parking.

This stunning apartment comprises spacious living and entertaining space with a beautiful reception room with superb views of the Grand Union Canal, a splendid modern fitted open plan kitchen, three bedrooms(with water views), two bathrooms and ample storage space.

The apartment offers easy access to superb transport links such as Paddington Train Station (Elizabeth Line, Bakerloo, Hammersmith & City, Circle, District lines and Heathrow Express) and Edgware Road (Circle, District and Bakerloo lines).

Local Authority:

Council Tax Band: E

Lease: Add text here

Service Charges: Add text here

Ground Rent: Add text here

STURGES
LONDON

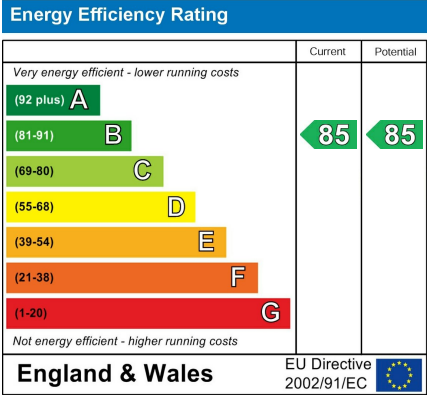
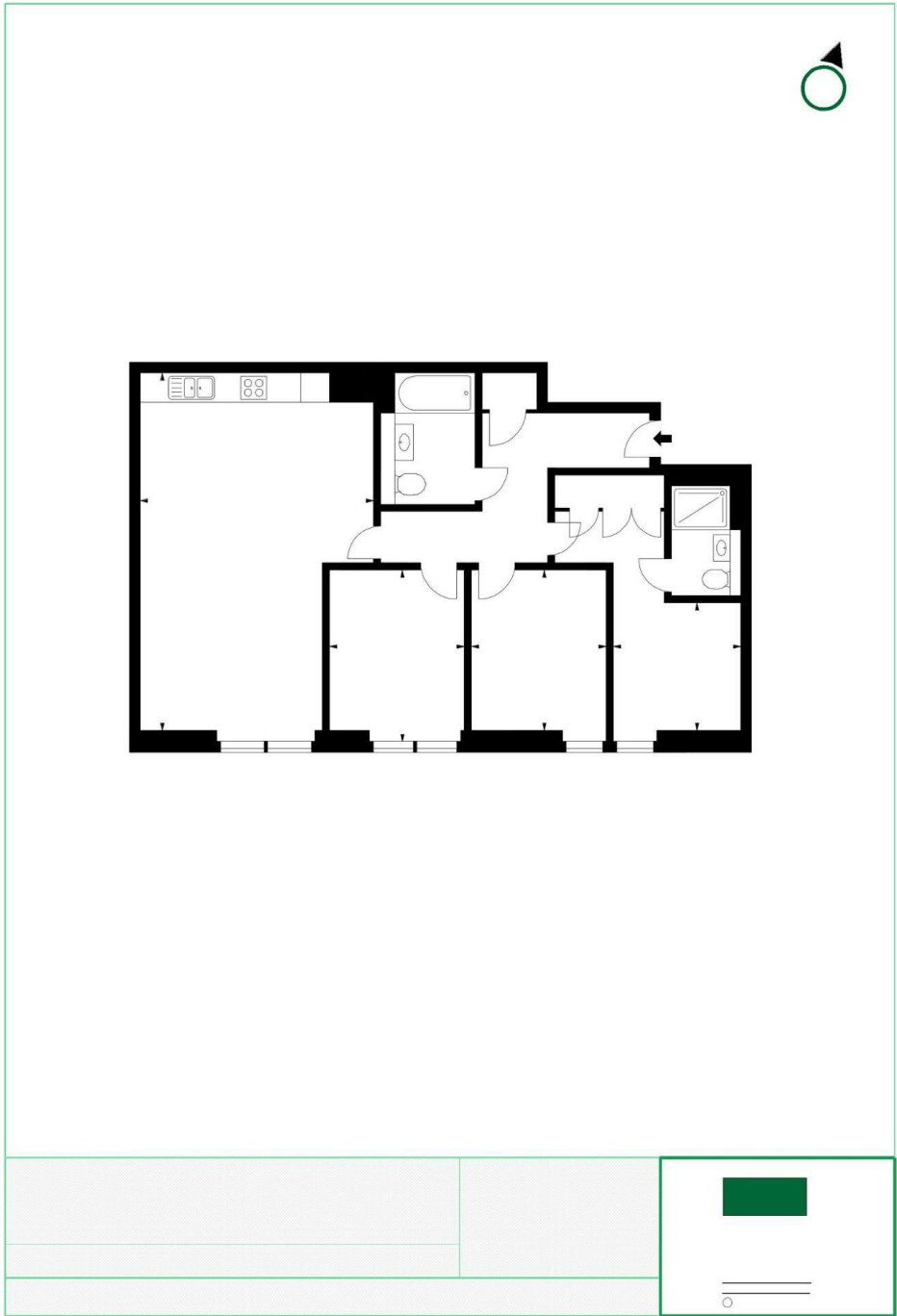

For more information, please contact:

(Tel) 020 3393 2002
(Email) hello@sturgeslondon.co.uk

668 Fulham Road, Parsons Green, London, SW6 5RX

sturgeslondon.co.uk

Agents Note: Whilst every care has been taken to prepare these particulars, they are for guidance purposes only. All measurements are approximate and for general guidance purposes only and whilst every care has been taken to ensure accuracy, they should not be relied upon and potential buyers/tenants are advised to recheck the measurements.